



VALENTINO

Linear Fire (balanced flue system)



BACK WALL FINISH



ACCESSORIES

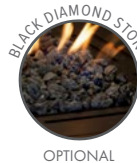

Thermostat / Thermostat / Termostato / Thermostat /
Termostato / Термостат



Gas and CO detectors / CO- und Gas-Sensor / Sensor de gas y CO / Capteur de gaz et de CO /
Sensore gas e CO / Czujnik gazu i CO / Датчик газа и углеродного газа



Antireflective glass / Anti-reflektierendes Keramikglas / Cristal cerámico anti-reflejos /
Verre anti-reflet / Vetro antiriflesso / Szkło antyrefleksyjne / Антибликовое стекло



Modular burner / Modulbrenner / Quemador modular / Brûleur modulaire /
Bruciatore modulare / Modulowe palenisko / Модульная горелка



	NATURAL GAS OR LPG	
	VALENTINO F (1000 mm)	VALENTINO F (1300 mm)
	max. 6.4 kW (NG) / max. 6.7 kW (LPG)	max. 8.5 kW (NG) / max. 7.4 kW (LPG)
	max. 0.9 m ³ /h (NG) / max. 0.7 kg/h (LPG)	max. 1.2 m ³ /h (NG) / max. 0.78 kg/h (LPG)
	concentric flue / konzentrisches / conducto concéntrico / système concentrique / scarico concentrico / koncentryczny / коаксиальная система 200/130 mm	
	230 V / [US] 115 V	



FRONT



LEFT FRONT



RIGHT FRONT



LEFT FRONT RIGHT

VALENTINO FRONT

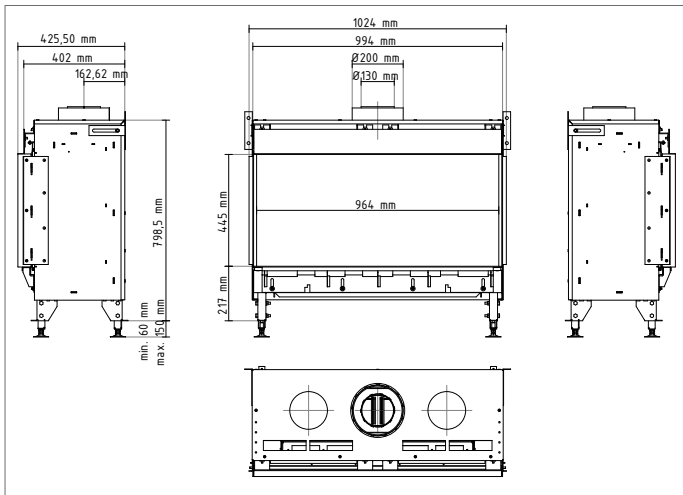

VALENTINO 1000

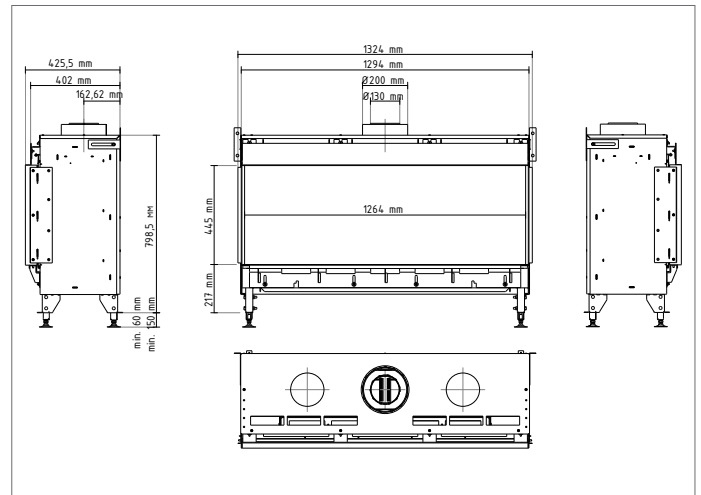

VALENTINO 1300

VALENTINO LEFT FRONT / RIGHT FRONT

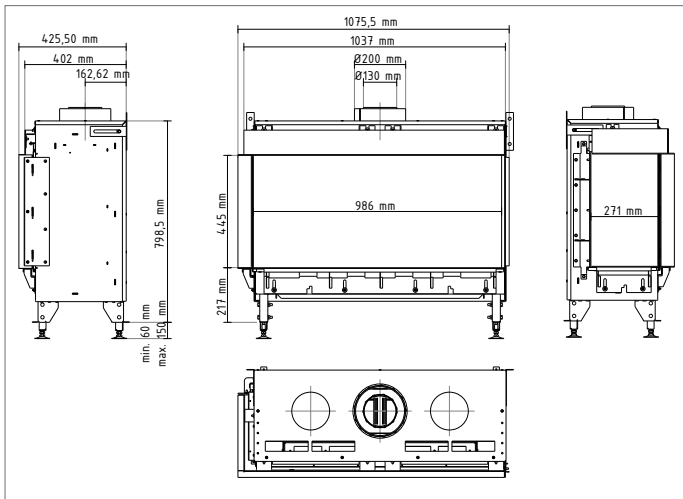

VALENTINO 1000

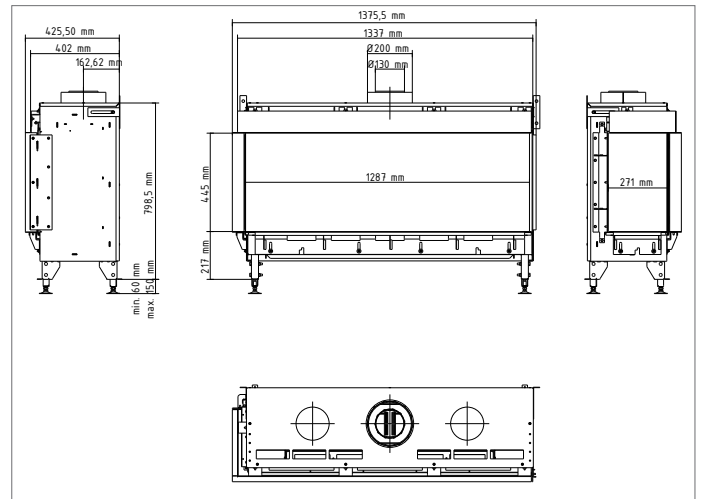

VALENTINO 1300

VALENTINO LEFT FRONT RIGHT

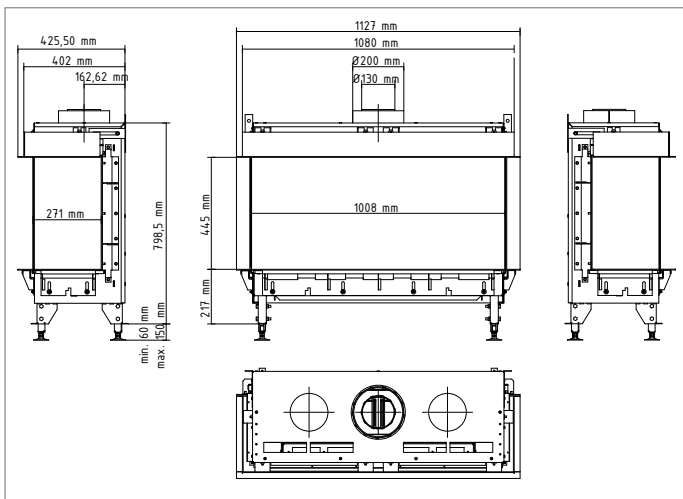

VALENTINO 1000

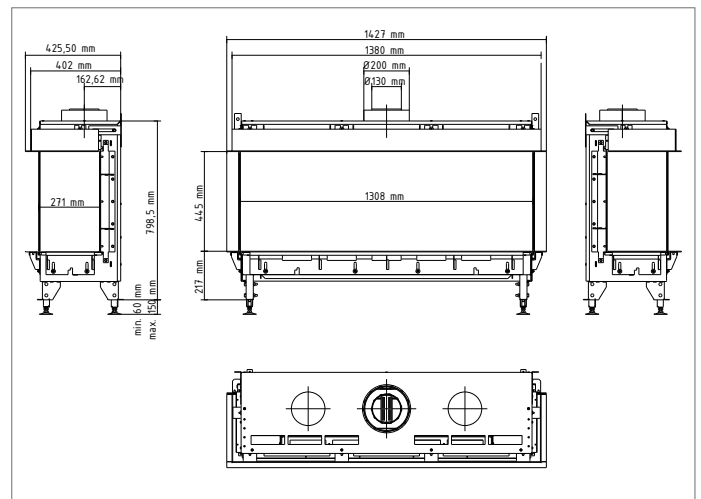

VALENTINO 1300